

# Installation Guide

- For an exhaust fan to perform at maximum efficiency, the key requirement is a balanced airflow. This will encourage a “cross breeze” which is essential to clear either vapor or odors.
- If a wall or window fan is installed, it should be as high as possible.
- Do not position the fan close to air inlets, as this will encourage the fan to draw air from this source first.

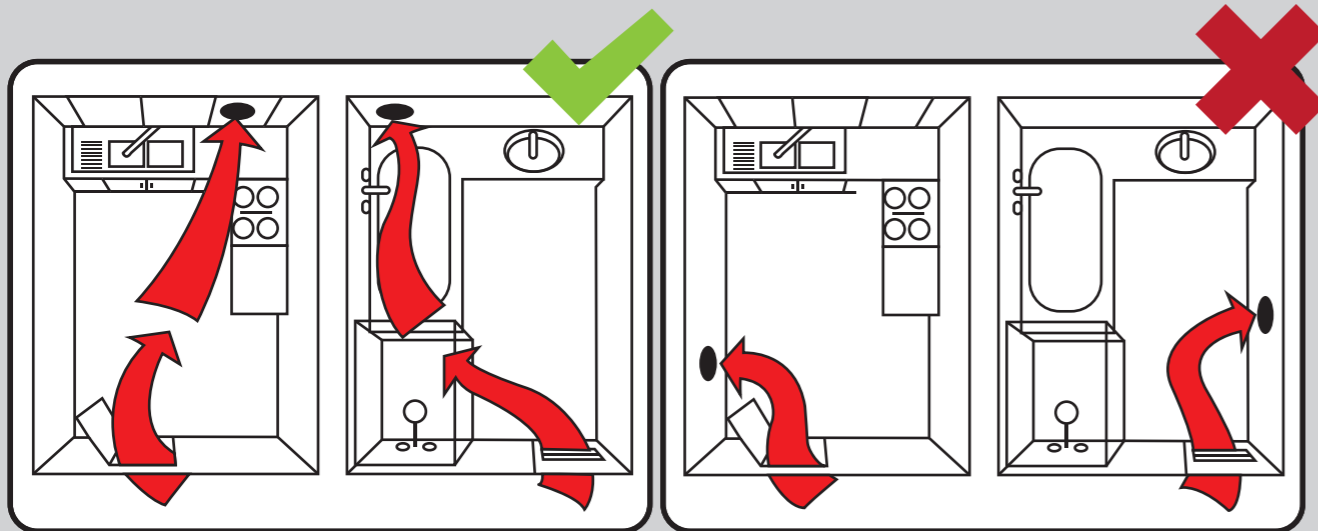

Correct Positioning

Wrong Positioning



## Exhaust Fans for Ceiling & Wall

**INNOVATIVE & UNIQUE**



VIC

NSW

QLD

SA

WA

Tel: (03) 9793 6111 (02) 9734 9944 (07) 3283 1199 (08) 8340 9200 (08) 9475 0777

Fax: (03) 9792 4509 (02) 9734 9933 (07) 3283 1170 (08) 8340 9211 (08) 9475 0788

Web/Email: [www.omegapower.com.au](http://www.omegapower.com.au) / [sales@omegapower.com.au](mailto:sales@omegapower.com.au)





## Ceiling Exhaust Fan with Built-in Draft Stopper

- EF200DS** 200mm (8") Ceiling Exhaust Fan
- EF250DS** 250mm (10") Ceiling Exhaust Fan

### BENEFITS

- Aerodynamically designed 5 Blade Fan and Grille to give smoother, quieter air flow and enhanced performance
- Easy Installation
- Complies with Energy Rating
- Energy Saving
- Ductable



### Specification

Part No.	EF200DS	EF250DS
Size	200mm (8")	250mm(10")
High Air Flow	550CBM/Hr = 152Lts/Sec	750CBM/Hr = 208Lts/Sec
Cut Out Size	220mm	270mm
Voltage	220-240V ~ 50Hz 35W	
Gravity Controlled Draft Stopper	Yes	
Ball Bearing Motor	Yes	
for Continuous Running		



Both with Built-in Draft Stopper  
Approved for use in shower recesses and similar restricted areas



## SLIMLINE Wall Exhaust Fan with Optional External Gravity Louvre

- E8GMGL** 200mm (8") Wall Exhaust Fan

### BENEFITS

- Aerodynamically designed 5 Blade Fan with Snap-on Grille OR Gravity Controlled Louvre for smoother, quieter air flow and enhanced performance
- Easy Installation
- Complies with Energy Rating
- Energy Saving

### Specification

Part No.	E8GMGL
Size	200mm(8")
High Air Flow	550 CBM/Hr = 152 Lts/Sec
Cut Out Size	240mm
Voltage	220-240V ~ 50Hz 35W
Wall Thickness	45 ~ 90mm
Gravity Controlled Louvre	Yes
Ball Bearing Motor	Yes
for Continuous Running	

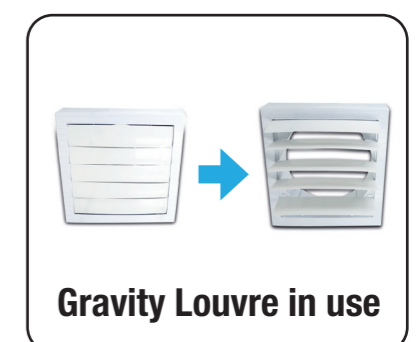
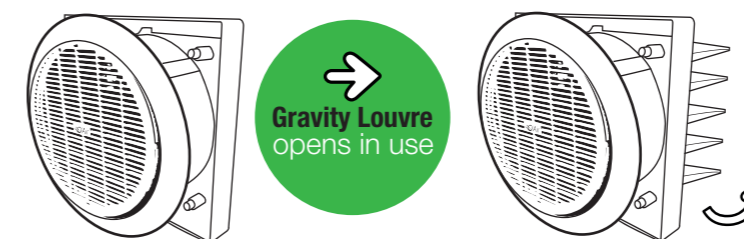

Approved for use in shower recesses and similar restricted areas